

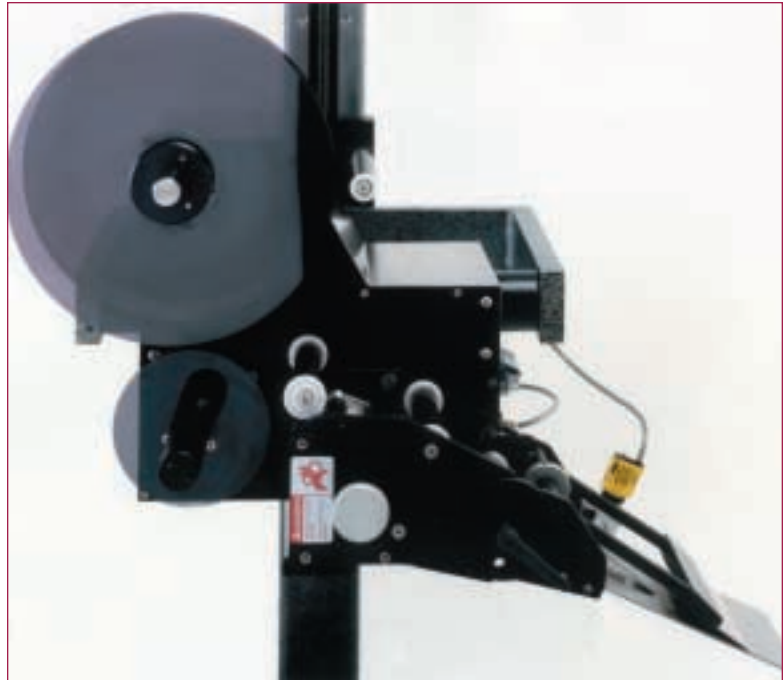

ST1100

Automatic Label Applicator



- Heavy-duty construction designed for industrial applications.
- User-friendly operator interface (ST1100-I Interface Shown).
- Microprocessor controller for flexible, accurate label placement.
- Stainless steel and anodized aluminum provide protection from corrosive environments.
- Pivoting peel plate.
- Solid drive construction ensures even pressure to the label web resulting in extremely accurate label placement.
- The applicator head can be oriented to any attitude for side, top or bottom placement.
- Outboard supported drive roller, nip roller and peel edge.
- Handles a full assortment label shapes and sizes.

The ST1100 Automatic Label Applicator is a high performance labeling head capable of speeds up to 1100 linear inches per minute. It comes complete with a direct drive DC stepper motor, powered rewind, a 6.5" web width, and a standard 12" diameter label roll capacity. Under microprocessor control, the ST1100 is accurate to $\pm 1/32$ of an inch.

The ST1100-I is utilized with fully integrated IDT solutions, while the ST1100-S is used for stand-alone applicators.

ST1100 Automatic Label Applicator

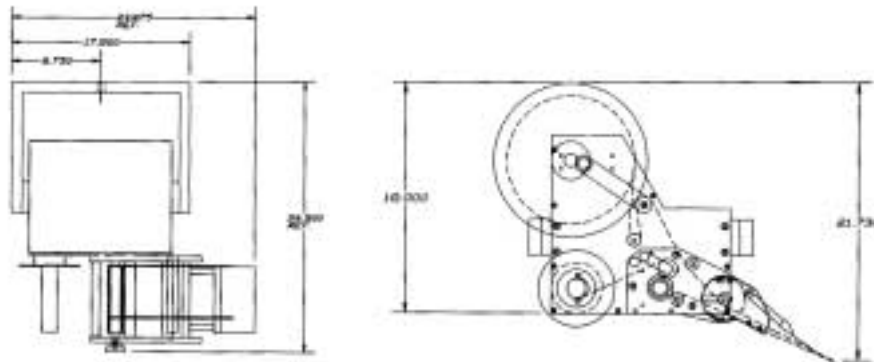

Note: All photography and dimensional drawings depict representative examples of systems. Dimensions, options and controls vary by application.

ST1100 Label Applicator Specifications

Speed	1100 linear inches per minute
Accuracy	± 1/32" with consistent product dimensions and favorable product handling
Control Electronics	Microprocessor Controller
Label Size	Minimum: Wipe-on: 0.5" by 0.5"; Wrap: 1" by 1" Maximum: Wipe-on 6.5" by 18"; Wrap: 6.5" by 10"
Electrical	115 VAC, 50/60 Hertz, 5 Amps
Label Sensing	Photoelectric
Label Capacity	6.5" web width, 12" diameter label roll, 3" core
Options	Low Label Warning Out of Label Warning Web Break Warning Rate Compensation Label /Product Counters Clear Label Sensor Hot Stamp Imprinter Oversize Web Width Imprint Verification Others per Quotation



2051 Franklin Dr.
Fort Worth, TX 76106
888.438.3242
www.idtechnology.com